

AÉRÉ

BY LIVINGSPACE

Order Form

Dealer's Name: _____ Contact and Phone #: _____

Homeowner's Name: _____ Phone #: _____

Homeowner's Address: _____

Homeowner's Email: _____

Room Style	
Studio	<input type="checkbox"/>
Cathedral	<input type="checkbox"/>
Under Existing	<input type="checkbox"/>
CornerPosts:	
LS	<input type="checkbox"/>
Existing	<input type="checkbox"/>

Lineal Color	
White	<input type="checkbox"/>
Sand	<input type="checkbox"/>

Window Frame Color	
White	<input type="checkbox"/>
Sand	<input type="checkbox"/>
Bronze	<input type="checkbox"/>
Black	<input type="checkbox"/>
Clay	<input type="checkbox"/>

Flexiglaze	
Clear	<input type="checkbox"/>
Gray	<input type="checkbox"/>
Dark Gray	<input type="checkbox"/>
Bronze	<input type="checkbox"/>

Windows & Doors*	
Entry Door	ED
French Doors	FD
<i>Door Handle Black Satin</i>	
Horizontal Slider HS	
2 Lite	<input type="checkbox"/>
3 Lite	<input type="checkbox"/>
Vertical Slider VS	
3 Track	<input type="checkbox"/>
4 Track	<input type="checkbox"/>
<i>*available in twins and triples</i>	

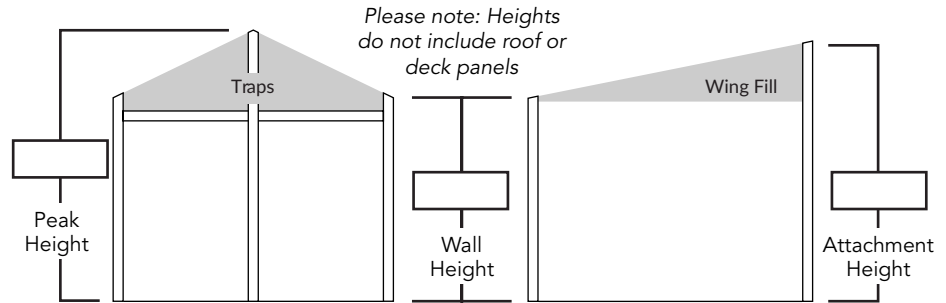

Pitch Max Height Inc. Roof Panels

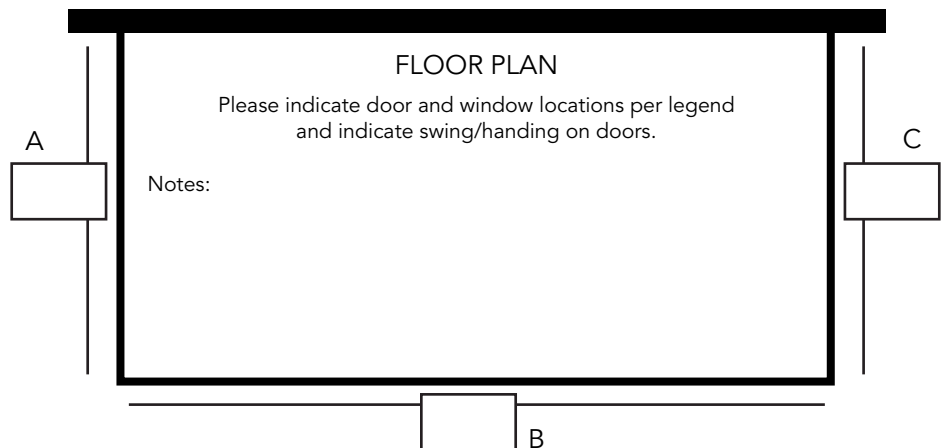

NOTE: Windows ALWAYS default to the widest available for the space indicated.
Additional openings can be specified (fees associated).

Knee Wall	
Site Built/Existing	<input type="checkbox"/>
Height	<input type="text"/>
Solid Integrated Fill*	<input type="checkbox"/>
<i>*horizontal sliders only</i>	

Transoms	
Memory Vinyl	<input type="checkbox"/>
No Transoms	<input type="checkbox"/>

Traps/Wing Fill	
Memory Vinyl	<input type="checkbox"/>
Solid Vinyl	<input type="checkbox"/>

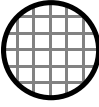
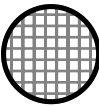
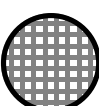
Screen Type	
 Standard	<input type="checkbox"/>
 BetterVue®	<input type="checkbox"/>
 TuffScreen®	<input type="checkbox"/>
No Screen	<input type="checkbox"/>

Notes:

AÉRÉ

BY LIVINGSPACE

Order Form

Homeowner's Name: _____

EcoGreen Pre-Cut Panel Info			
		12"	
<p>No fascia provided for plumb cut panels. (Chose one below)</p> <p> <input type="checkbox"/> OR <input type="checkbox"/> </p>			
<p> <input type="checkbox"/> Cut to length <input type="checkbox"/> Cut to length w/ plumb cut ridge only <input type="checkbox"/> Cut to length & plumb cut both ends </p>			
EcoGreen Roofing			
<div style="display: flex; flex-direction: column; align-items: center;"> <div>6" (R-24) <input type="checkbox"/></div> <div>8" (R-34) <input type="checkbox"/></div> <div>10" (R-43) <input type="checkbox"/></div> <div>12" (R-52) <input type="checkbox"/></div> </div>		→	<div style="text-align: center;">Type</div> <div>3 PLY (shingle) <input type="checkbox"/></div> <div style="font-size: small;">OSB, Foam, OSB</div> <div>4 PLY (shingle)* <input type="checkbox"/></div> <div style="font-size: small;">OSB, Foam, OSB, vinyl</div> <div style="font-size: x-small;">*Note: the vinyl skin on the 4-ply ECO roof system is not covered under warranty. While the roof panel itself is covered, the vinyl skin is excluded from warranty coverage.</div>
Aluminum Roofing			
<div style="display: flex; flex-direction: column; align-items: center;"> <div>6" <input type="checkbox"/></div> <div>Fan Beam Y <input type="checkbox"/> N <input type="checkbox"/></div> <div>Alu. Panels Only: Qty _____</div> </div>		→	<div style="text-align: center;">Type</div> <div>3 PLY <input type="checkbox"/></div> <div style="font-size: small;">Alu, Foam, Alu</div> <div>4 PLY <input type="checkbox"/></div> <div style="font-size: small;">Alu, OSB, Foam, Alu</div>
Lighting Components			
Type	Black	White	Quantity
3" LED Gimbal	<input type="checkbox"/>	<input type="checkbox"/>	
4" LED	<input type="checkbox"/>	<input type="checkbox"/>	
6" LED	<input type="checkbox"/>	<input type="checkbox"/>	
Engineering			
Stamped Generic <input type="checkbox"/>		Site Specific <input type="checkbox"/>	

If engineering is needed, please include a separate completed engineering form.

Notes:

Extruded aluminum fascia included with 6" 4 PLY EcoGreen panels. Fascia offered for 6" 3 PLY EcoGreen panels, but priced separately and must be noted. No fascia offered for 8", 10" and 12" panels.

Roof Panel and Ridge Beam specs are determined by LivingSpace Sunrooms and are based on 40 PSF snow load. Length determined by length of projection plus 12". If different requirements are needed please note.

Snow Load		
_____ psf		
Roof Extras		
	Y	N
Structural Ridge Beam	<input type="checkbox"/>	<input type="checkbox"/>
Aluminum Cover	<input type="checkbox"/>	<input type="checkbox"/>
Deluxe Ridge Beam Cover	<input type="checkbox"/>	<input type="checkbox"/>
Color		
Skylights	<input type="checkbox"/>	<input type="checkbox"/>
Quantity		
EcoGreen Deck		
Thickness	24" wide panels	
6" (R-24) <input type="checkbox"/>	Qty.	
8" (R-34) <input type="checkbox"/>		
10" (R-43) <input type="checkbox"/>	Length	
12" (R-52) <input type="checkbox"/>		
Electrical Components		
Type	Quantity	
Outlet		
Switch		

All electrical components come in white only and with a Jumbo Decora Cover Plate.